

NOTE: THIS DRAWING IS NOT TO SCALE

SQUARE MOUNTING PLATE

PL2 SQ

THICKNESS: 15mm

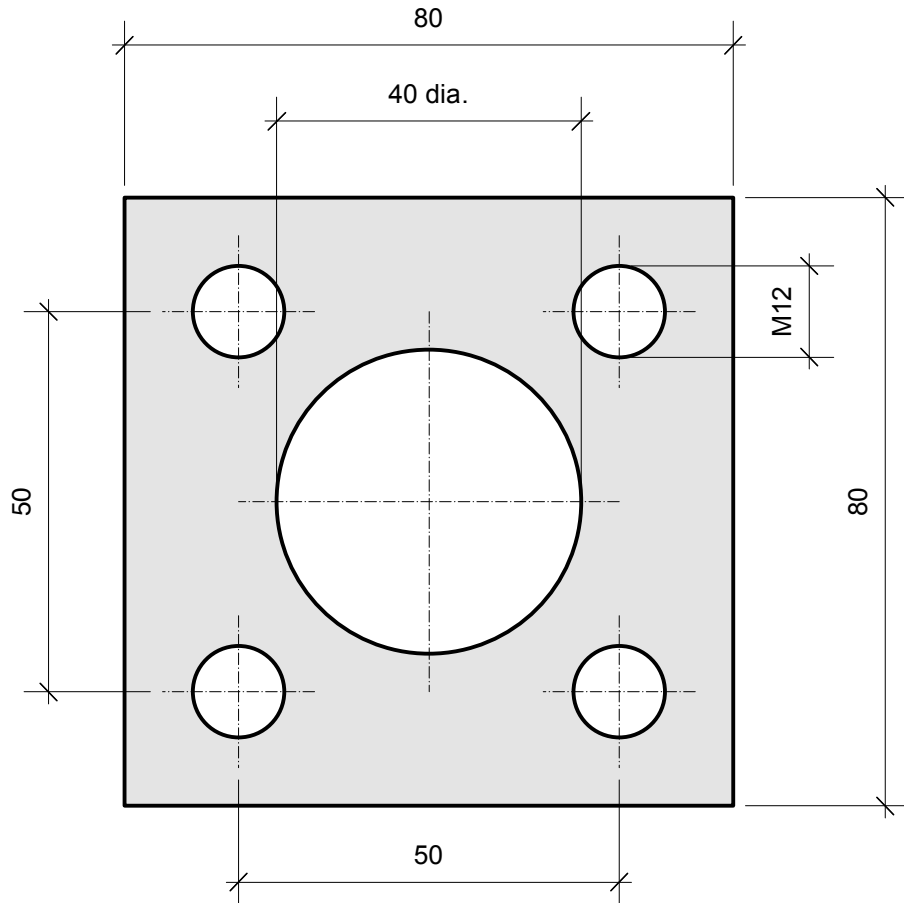

PLATE REFERENCE: PL2 SQ

WELD TO BEARING: 4.056 or 4.456 or 4.074 or 2.2077

USE WITH

STEEL CHANNEL: 2810