

NOTE: THIS DRAWING IS NOT TO SCALE

SQUARE MOUNTING PLATE

PL4 SQ

THICKNESS: 20mm

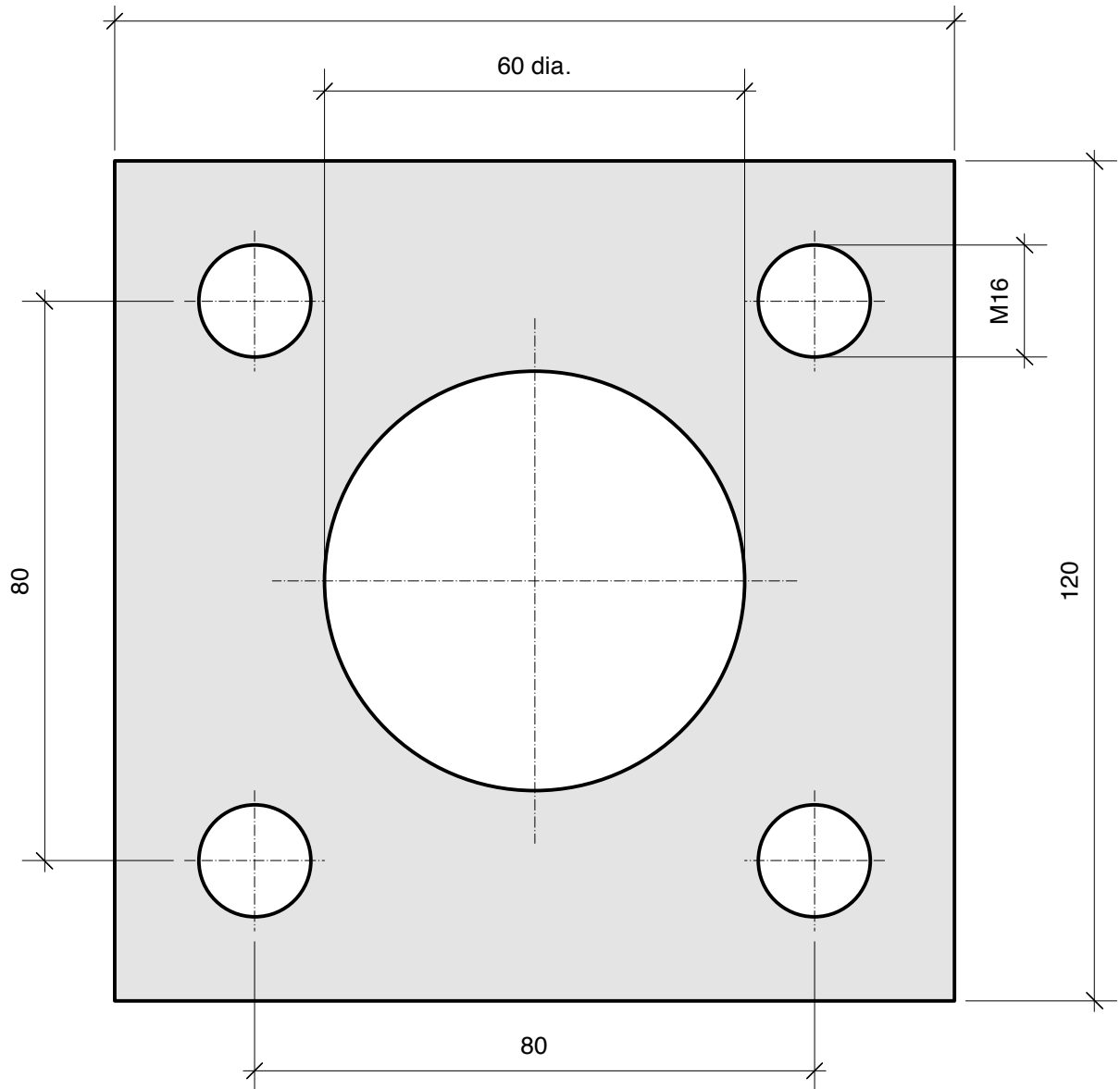

PLATE REFERENCE: PL4 SQ

WELD TO BEARING:

4.061 or 4.461 or 2.2107

4.062 or 4.462 or 2.2123

USE WITH

STEEL CHANNEL: 2862 or 2891

www.euro-bearings.com

