

# TORQUE RESISTANT FLANGED BALL BEARINGS

The torque resistant flanged ball bearings have all the same characteristics as described on the previous page but have the advantage of being easily secured in position via the flange.

Please note shaft diameters 6, 8 & 10 have a flange that has been cut away (see left hand drawing below).

Shaft diameters 14 to 60 have a round flange (right hand drawing below).



See website for full range of sizes

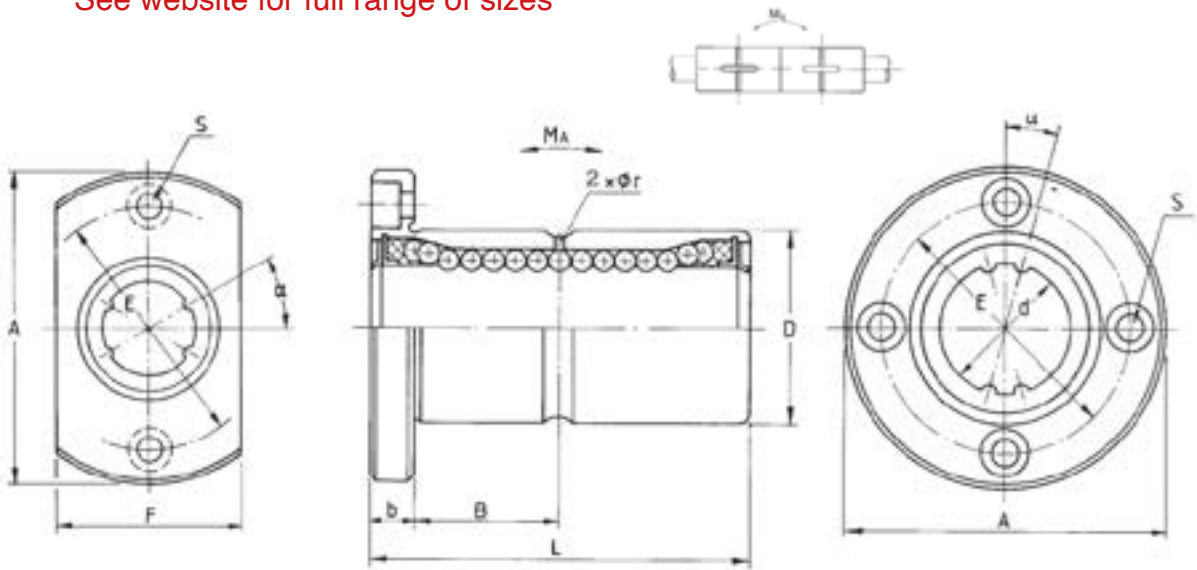

PART	h7 d	D	L	b	A	B	E	F	r	S	α	Torque		Load		Moment		Weight (kg)
												C <sub>T</sub> (Nm)	C <sub>OT</sub> (Nm)	C (kN)	C <sub>0</sub> (kN)	M <sub>A</sub> (Nm)	M <sub>B</sub> (Nm)	
SPF4-306	6	14	25	5	30	7.5	22	18	1.0	M3	30	1.5	2.4	1.22	2.28	5.1	40	0.03
SPF4-308	8	16	25	5	32	7.5	24	21	1.5	M3	30	2.1	3.7	1.45	2.87	7.4	50	0.04
SPF4-310	10	21	33	6	42	10.5	32	25	1.5	M4	30	4.4	8.2	2.73	5.07	18	116	0.08
SPF4-314	13	24	36	7	43	11	33	-	1.5	M4	25	21	40	2.70	4.90	13.7	109	0.10
SPF4-316	16	31	50	7	50	18	40	-	2.0	M4	25	60	110	6.15	11.20	46	299	0.20
SPF4-320	18.2	32	60	7	51	23	40	-	2.0	M4	16	85	136	8.00	11.50	64	500	0.22
SPF4-325	23	37	70	9	60	26	47	-	3.0	M5	16	165	244	12.6	16.40	106	830	0.32
SPF4-330	28	45	80	10	70	30	54	-	3.0	M6	16	295	420	19.0	23.7	185	1470	0.51
SPF4-340	37.4	60	100	14	90	36	72	-	4.0	M8	16	650	900	31.4	38.3	365	2940	1.15
SPF4-350	47	75	112	16	113	40	91	-	4.0	M10	16	1420	3240	47.0	75.7	710	4400	2.10
SPF4-360	56.5	90	127	18	129	45.5	107	-	4.0	M10	16	2100	4800	58.0	127.0	1300	8800	3.30